



## Reliable window joints made easy

Installation guide for the CONTEGA system

Internal airtightness

External weather protection

Sub-sill flashing

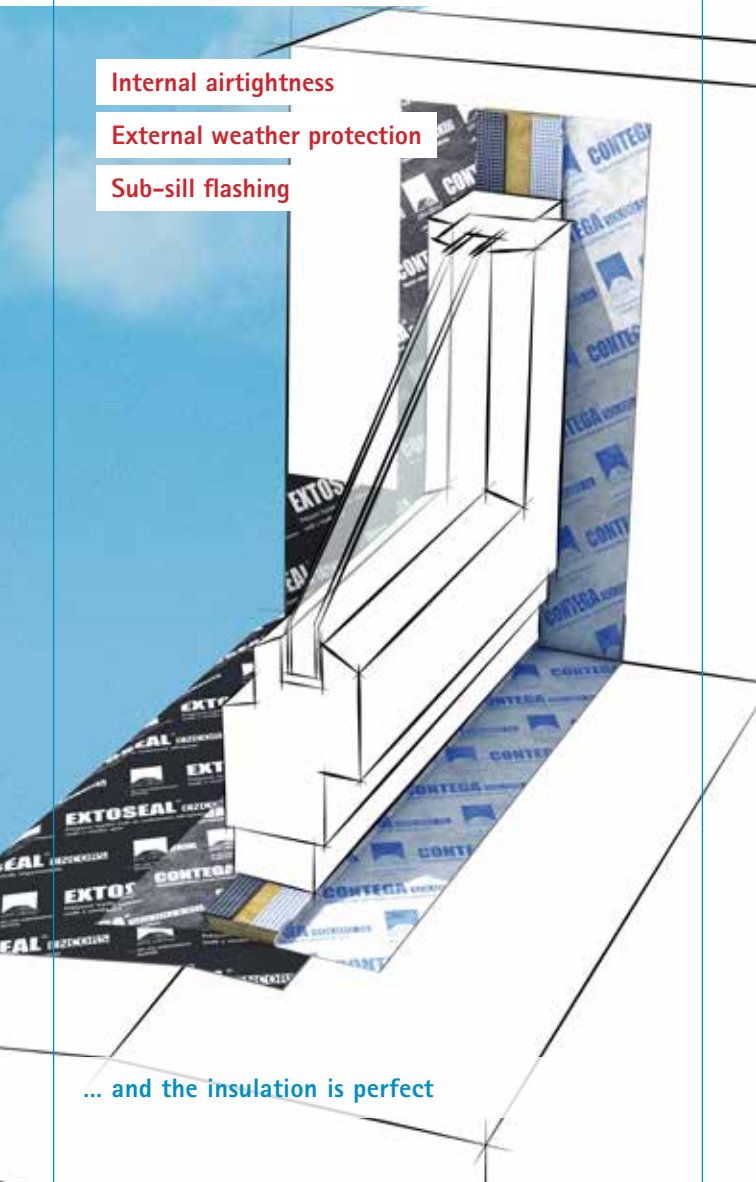

... and the insulation is perfect

## Simple implementation of reliably sealed joints around modern windows

### 1. Internal airtightness

The entry of cold outdoor air into structures and the air flow through these structures is prevented. Mould, air currents and energy losses are avoided in this way.

### 2. Functional zone

Joint gaps are filled with a suitable insulation material. This helps to minimise thermal bridges.

### 3. External weather protection

The exterior sealing provides protection against driving rain and wind. It prevents the uncontrolled entry of moisture into the building structure and thus provides protection against moisture damage.

The sub-sill flashing serves a second water-draining layer and provides additional protection against penetrating water underneath the window sill.

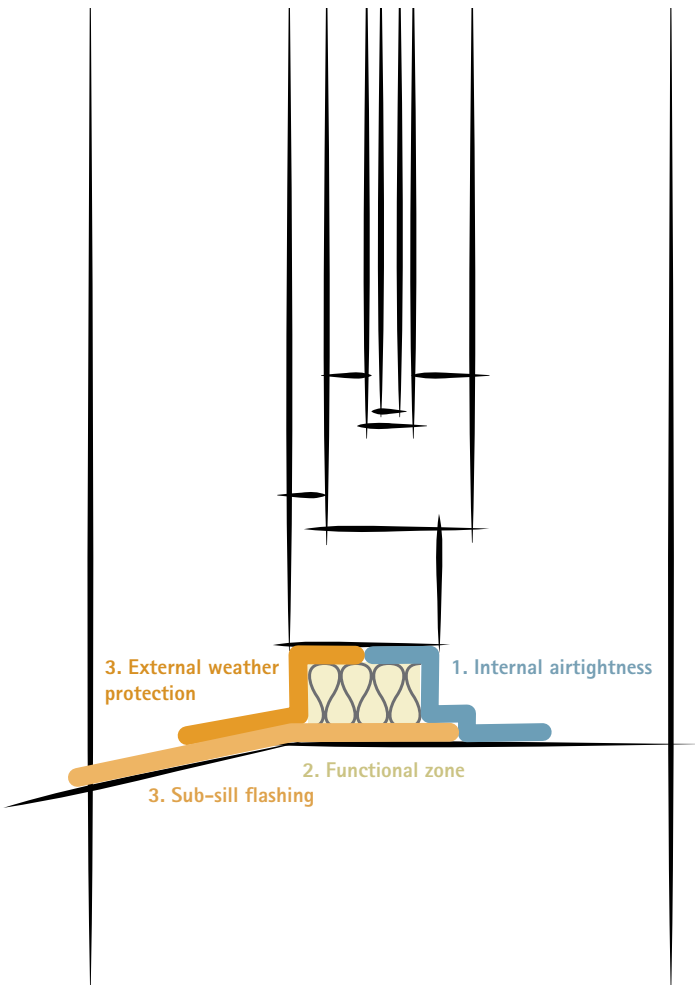

## Perfectly sealed joints made easy

■ Check the subsurface	p. 6
■ Preparation for interior airtightness	p. 7
■ Preparation for exterior weather protection	p. 16
■ Installation of sub-sill flashing	p. 20
■ Installation of the window	p. 25
■ Finishing the interior airtightness	p. 27
■ Insulating the joint	p. 30
■ Finishing the weather protection	p. 31
■ Installation in front of the wall	p. 33
■ Quality assurance, acceptance and documentation	p. 41

### Installation guide for: Facade windows

## Checklist – My pro clima products

- **CONTEGA<sup>®</sup> SOLIDO SL-D**  
Full-surface adhesive plaster/  
window-sealing tape with  
an additional adhesive zone,  
for interior use



#### Product variant

- **CONTEGA<sup>®</sup> SOLIDO IO-D**  
Intelligent full-surface  
adhesive plaster/window-  
sealing tape with additional  
adhesive zone, for interior  
and exterior use



- **CONTEGA<sup>®</sup> SOLIDO EXO-D**  
Full-surface adhesive plaster/  
window-sealing tape with  
an additional adhesive zone,  
for exterior use



- **EXTOSEAL<sup>®</sup> ENCORS**  
Waterproof sealing tape  
with high adhesive strength



Test report no. 16-000527-P902  
(PB 2-653-000310-de-01)  
EXTOSEAL ENCORS sub-sill flashing  
with CONTEGA SOLIDO EXO  
as per M04711-1-2007-01-c  
24 June 2016



- **PRESSFIX**  
Pressing aid for pro clima  
adhesive tapes





## Check the subsurface

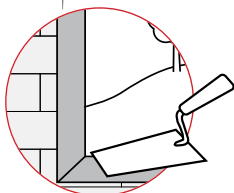
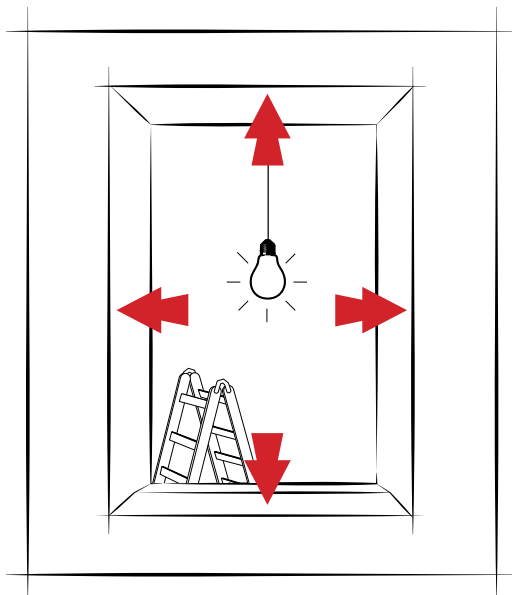

A smooth plaster finish must be present on the masonry

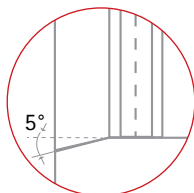

There must be a fall

### Check the state of the subsurface

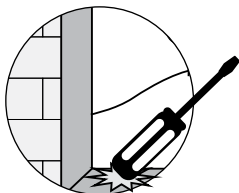

Stability

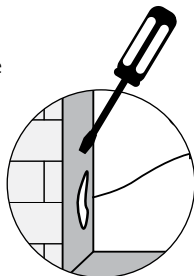

Internal stability



Free of frost



Free of grease and oil



Clean / brush off



## Preparation for interior airtightness

### 1. Clean the perimeter of the window frame

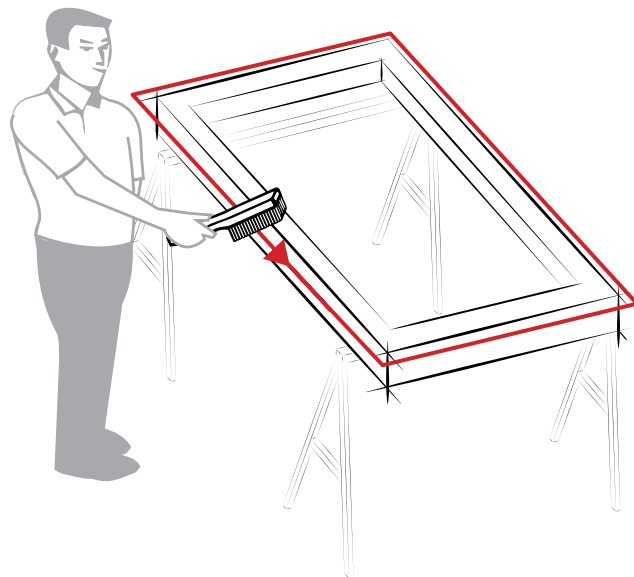

If the CONTEGA window-sealing tapes are to be plastered over subsequently, ensure that at least 50% of the reveal and a maximum of 60 mm (2 3/8") tape width are covered by the plaster.



The corner areas of window profiles, clip-on profiles and wideners etc. are to be implemented in a manner that is airtight and/or resistant to driving rain.

#### Practical tip:

Stick CONTEGA window-sealing tapes to the frame before installing the window: simple application of the adhesive tape – reliable sealing – valuable time saved!



## 2. Stick CONTEGA SOLIDO SL-D on the inside of the frame

### CONTEGA<sup>®</sup> SOLIDO SL-D

Full-surface adhesive plaster/  
window-sealing tape with an  
additional adhesive zone,  
for interior use

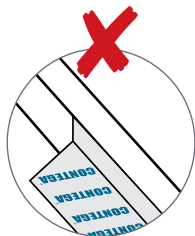
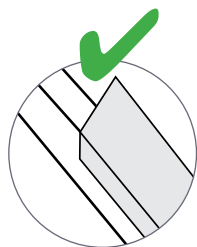
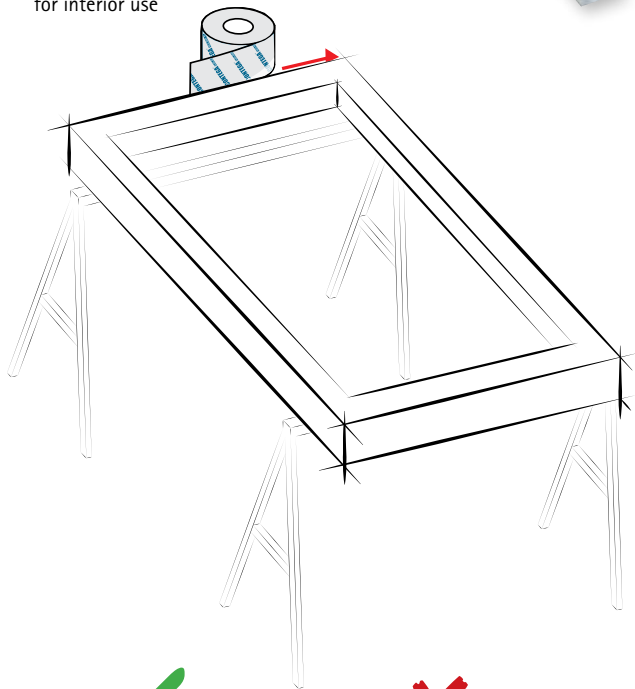

Ideally you should start at the top. Overlap the tape ends by at least 2 cm (7/8"). There must be no tape overlaps in the area around the sub-sill flashing. All overlaps are to be implemented in a waterproof manner.



## 3. Create loops of slack at the corners

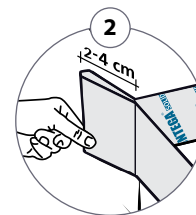
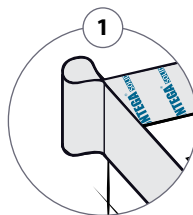
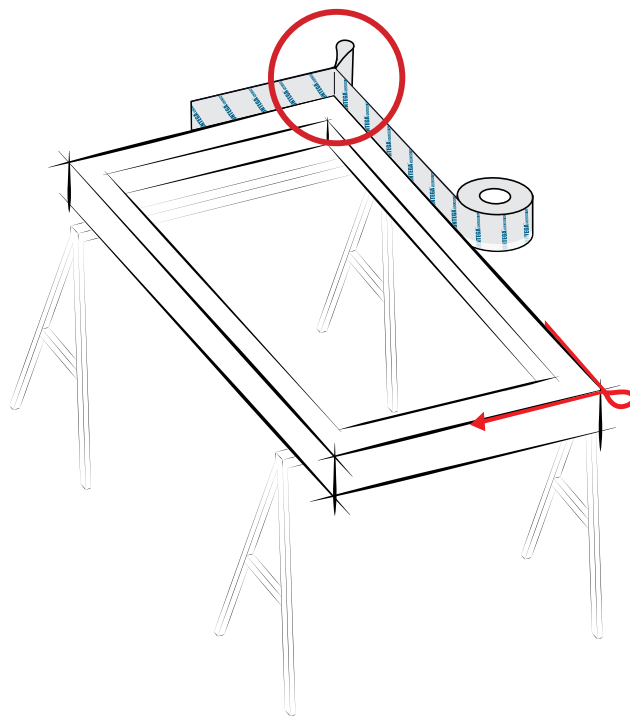

Why create slack loops at the corners? This is done so that the tape can then be folded out again at the reveal corners after the window has been inserted and can be stuck in a secure, airtight manner. The corner slack should be approx 2-4 cm (7/8"-1 5/8"), i.e. approx. 1.5 times the joint width. Press the ends of the corner slack loops together forcefully.



#### 4. Stick CONTEGA SOLIDO SL-D around the perimeter of the frame

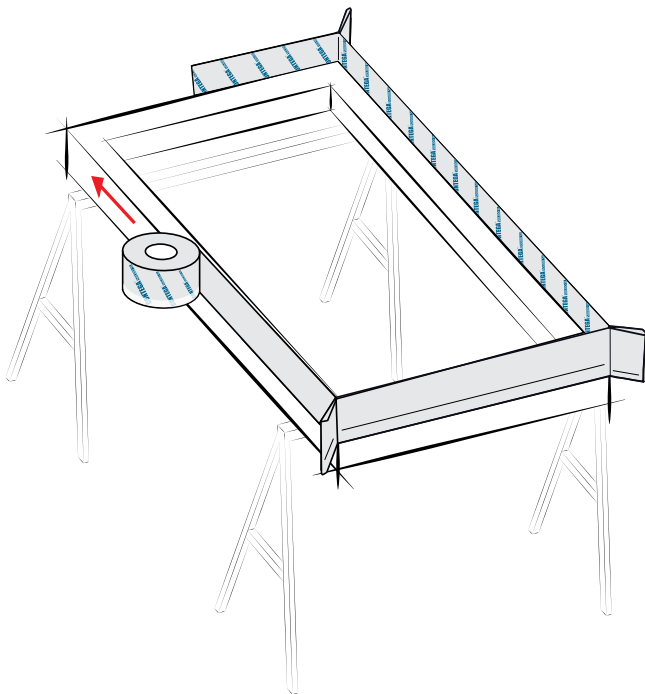

#### 5. Stick the ends

Remove the release film completely and stick in place with approx. 2-5 cm (7/8"-2") of an overlap. Rub firmly with the PRESSFIX application tool.

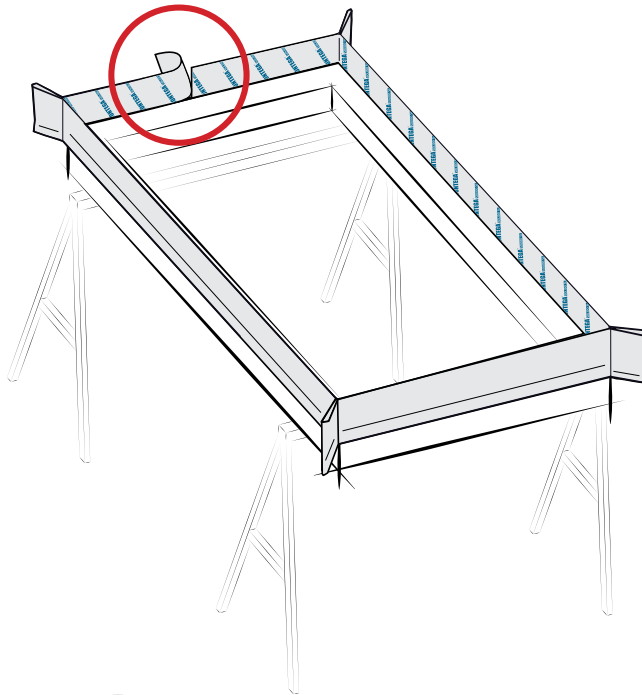



### 6. Press down firmly on the adhesive tape

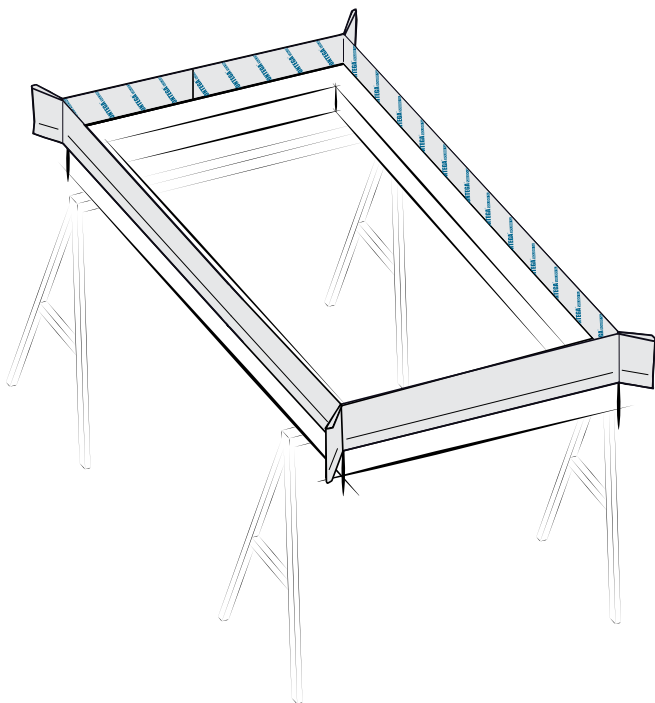

**PRESSFIX**  
Pressing aid for pro clima  
adhesive tapes



### 7. Window frame on the interior side

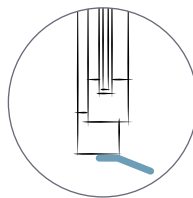
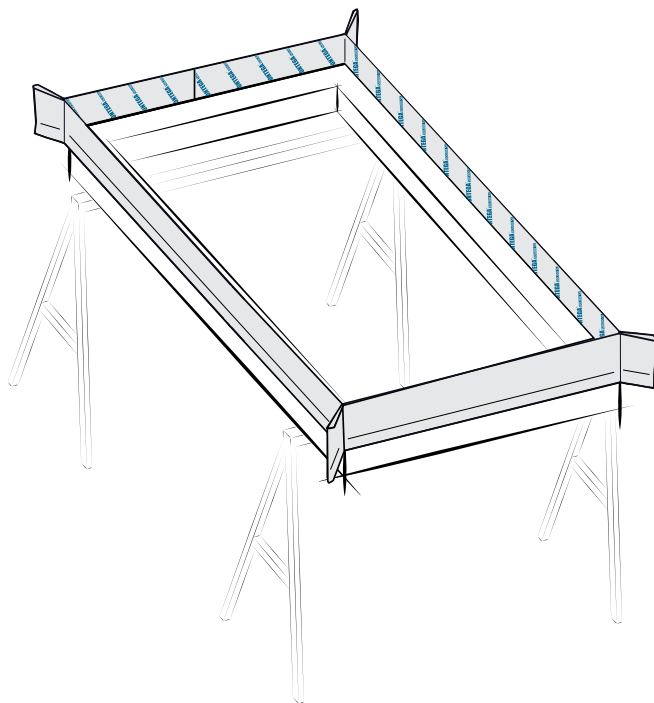

**You're finished!**

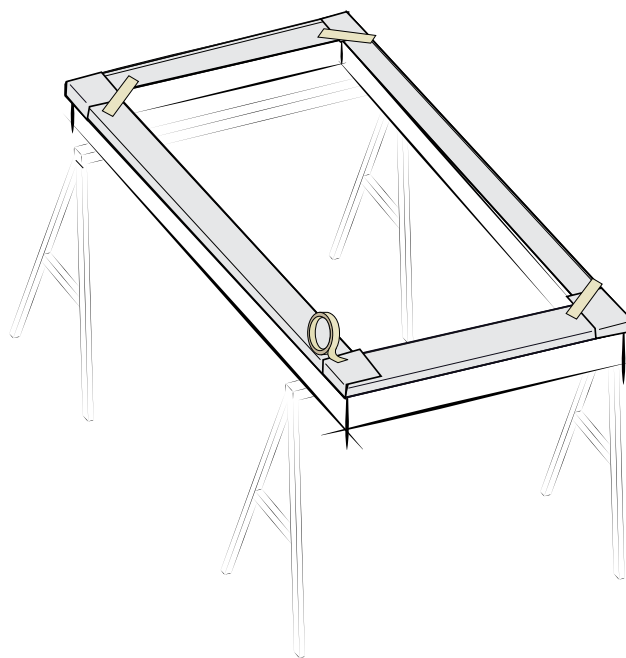
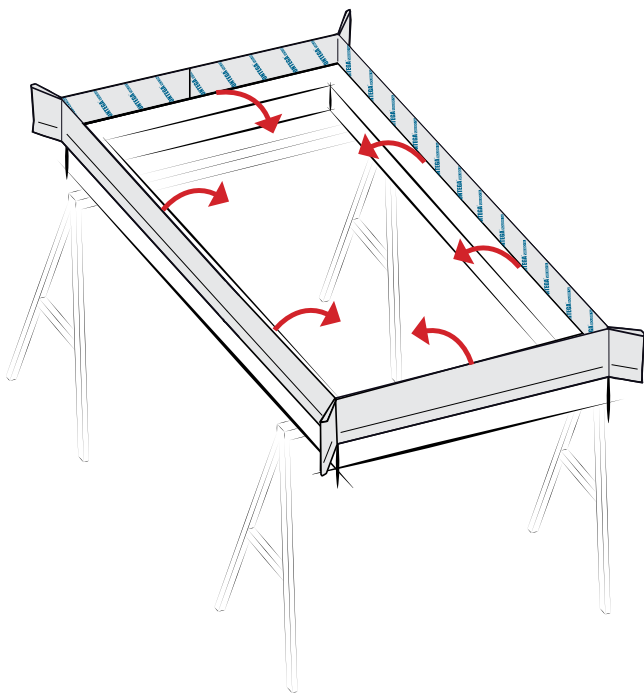
**Practical tip****Practical tip:**

Hold the tape in place temporarily with removable adhesive tape to make it easier to slide the window into the window opening.

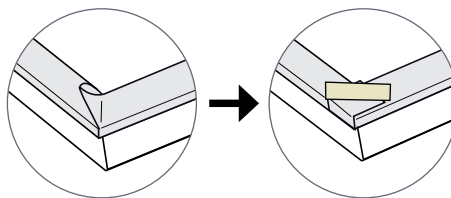
**Removable adhesive tape**





## Preparation for exterior weather protection

1. Turn the frame over

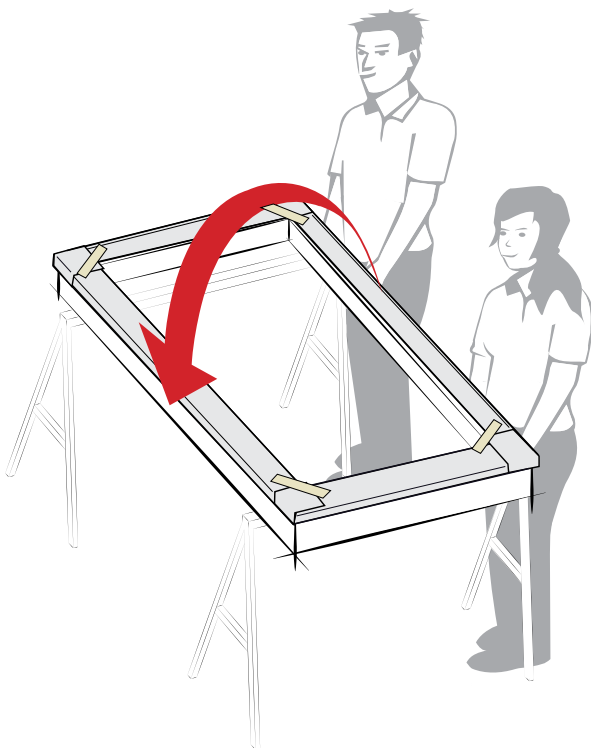

2. Stick CONTEGA SOLIDO EXO-D onto the exterior side of the frame. » Repeat steps 2 to 7

### CONTEGA<sup>®</sup> SOLIDO EXO-D

Full-surface adhesive plaster/  
window-sealing tape with an  
additional adhesive zone, for  
exterior use

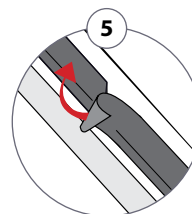
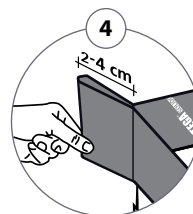
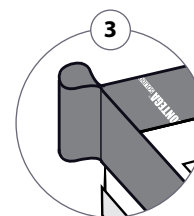
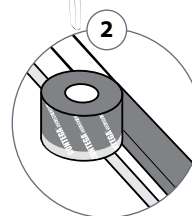
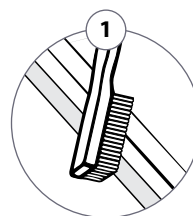
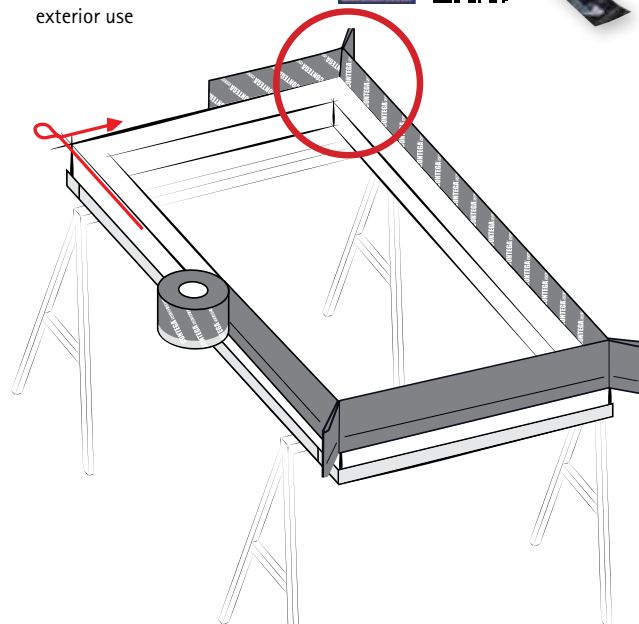
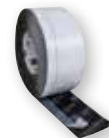



### Product variant

## CONTEGA<sup>®</sup> SOLIDO 10-D

Intelligent full-surface adhesive plaster/  
window-sealing tape with additional  
adhesive zone, for interior and exterior use



Just one tape for interior and exterior use: Humidity-variable  $s_d$  value  
for dry window joints. One tape for inside and outside means easier  
stock management too!

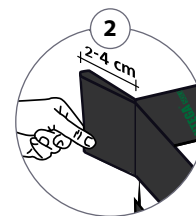
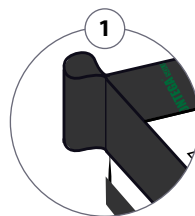
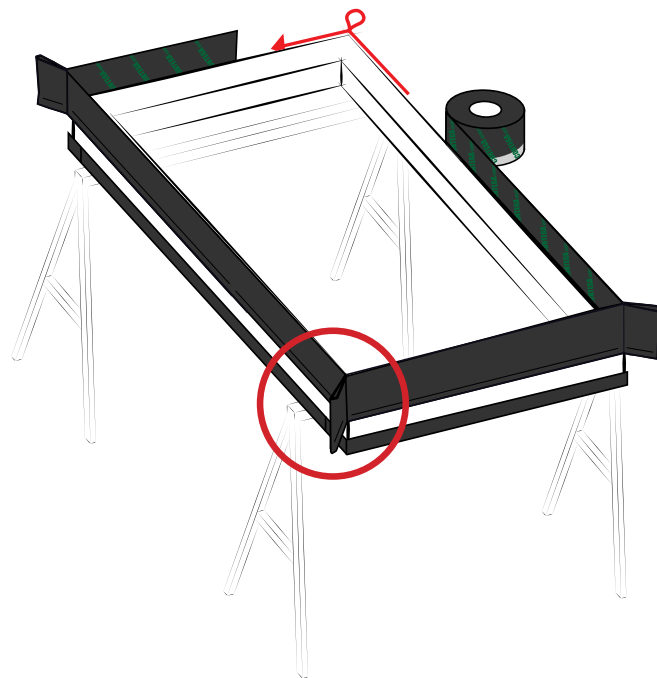
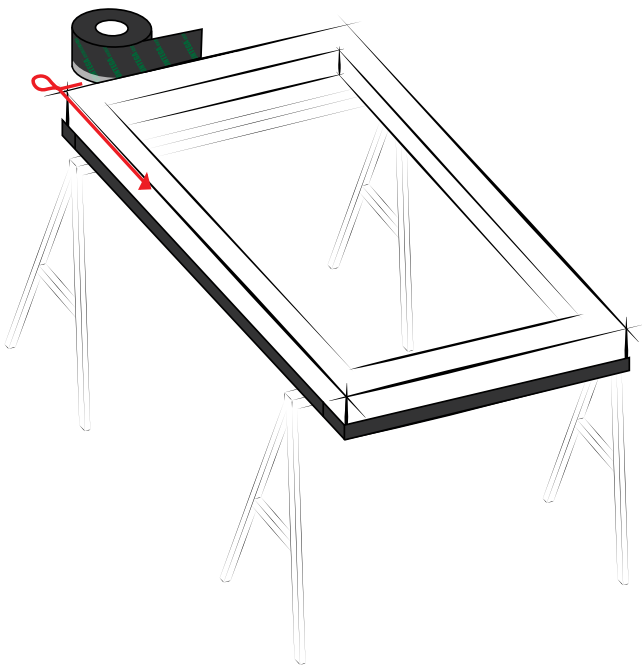



## Installation of sub-sill flashing

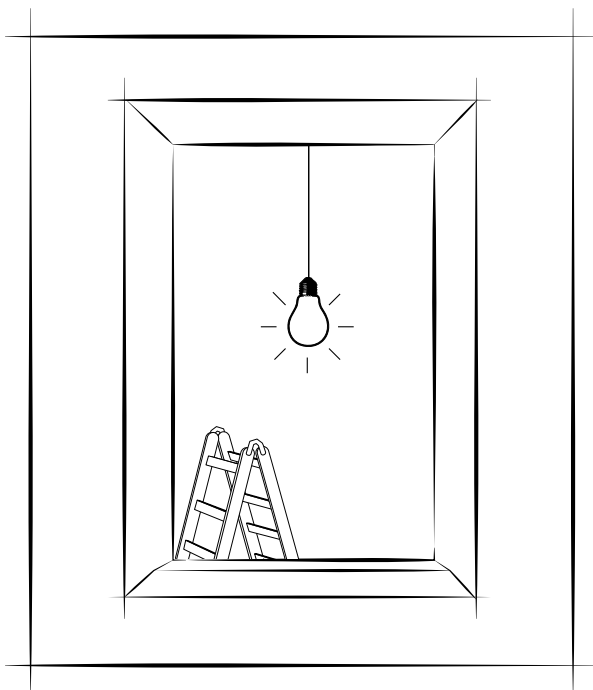

### Practical tip: Install an insulation wedge

An insulation wedge can be used to create an inclined run-off, and to help avoid thermal bridges.



### 1. Cut EXTONSEAL ENCORS to size, allowing for excess

**EXTONSEAL** ENCORS

Water-resistant adhesive tape with high adhesive strength

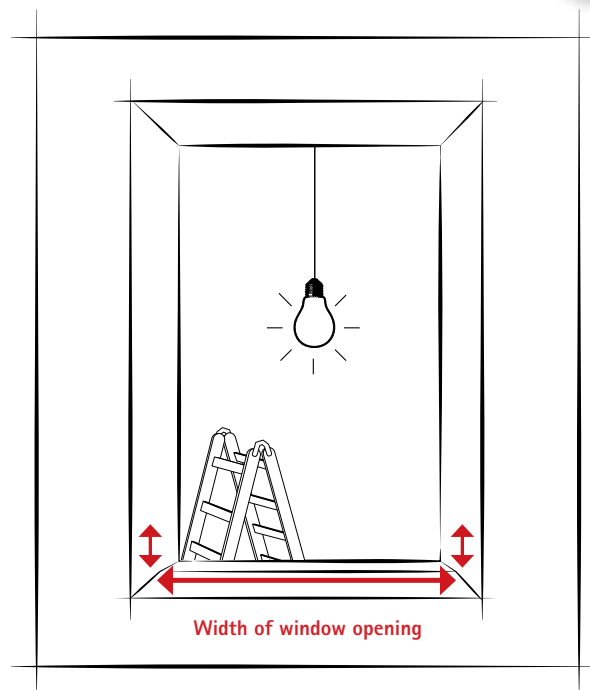

Allow for an additional length of tape for the reveal sides, depending on the subsequent installation procedure:

- approx. 6 cm (2 3/8") for a directly plastered window reveal.
- approx. 10-15 cm (4" to 6") for rear-ventilated structures or other material layers; capillary suction can reach a height of 10 cm (4")



2. Remove the wide release film and stick EXTONSEAL ENCORS onto the window sill.

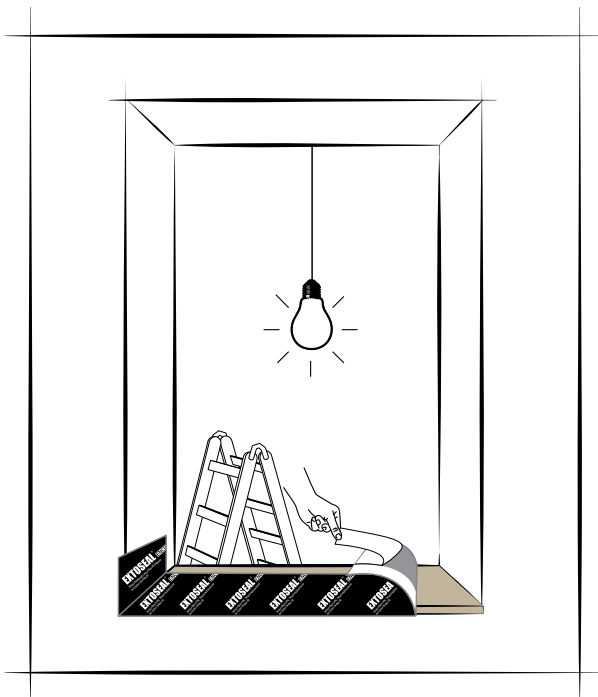

Stick to the reveal sides.



Guide the EXTONSEAL ENCORS tape right into the corners and rub firmly into place. Select the width of EXTONSEAL ENCORS so that it protrudes behind the vertical window profile by at least approx. 2 cm (7/8"). Lengths of tape can be stuck together with an overlap of approx. 2-3 cm (7/8"-1 3/16") to create larger areas.



3. Cut off excess tape at window reveals

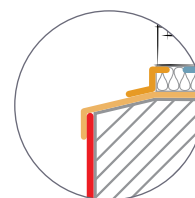
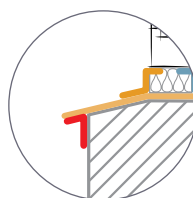
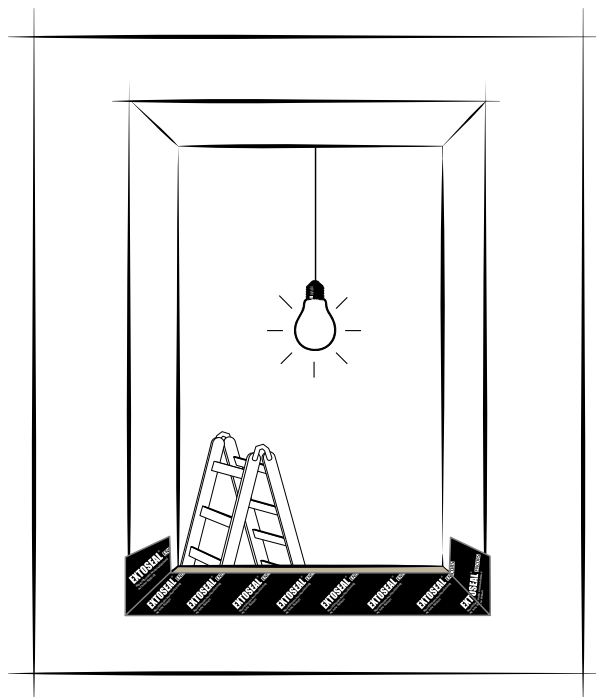

Depending on the type of facade used, EXTONSEAL ENCORS is continued onto a drip profile or a facade membrane.

**Practical tip:**

Installation is easier if the side with the narrow release film protrudes on the outside. EXTONSEAL ENCORS can be installed with full-surface adhesion as a temporary protection measure during the construction period.



#### 4. Stick EXTOSEAL ENCORS in place

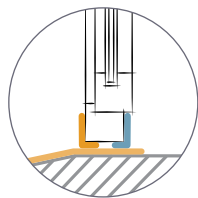
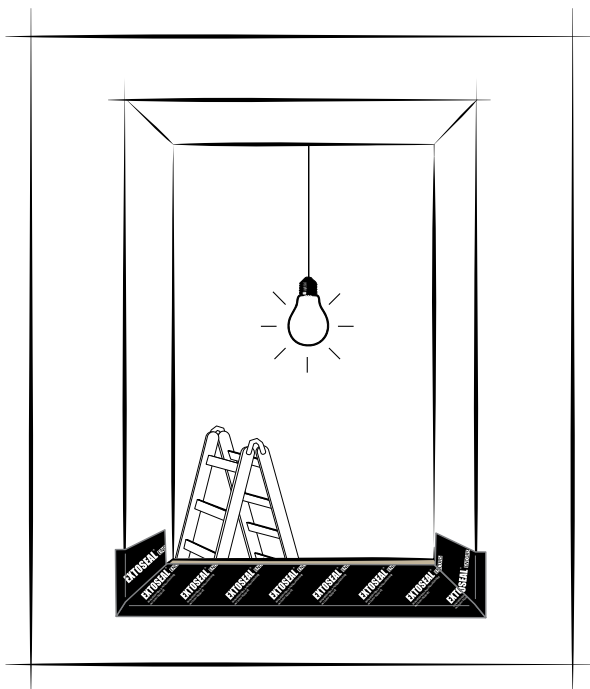

You're finished!



Guide the EXTOSEAL ENCORS tape right into the corners and rub firmly into place. EXTOSEAL ENCORS cannot be plastered over (see pages 7 and 21); fit a reveal plate before plastering, or else tape over with TESCON VANA and add suitable reinforcement to the plaster. In this example, EXTOSEAL ENCORS is shown as sub-sill flashing as part of a rear-ventilated system. In the case of a thermal insulation composite system (TICS), installation of the sub-sill flashing should be adapted as necessary.



## Installation of the window

### 1. Mount the window

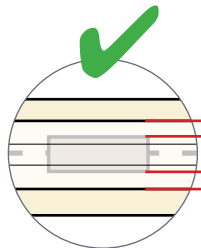
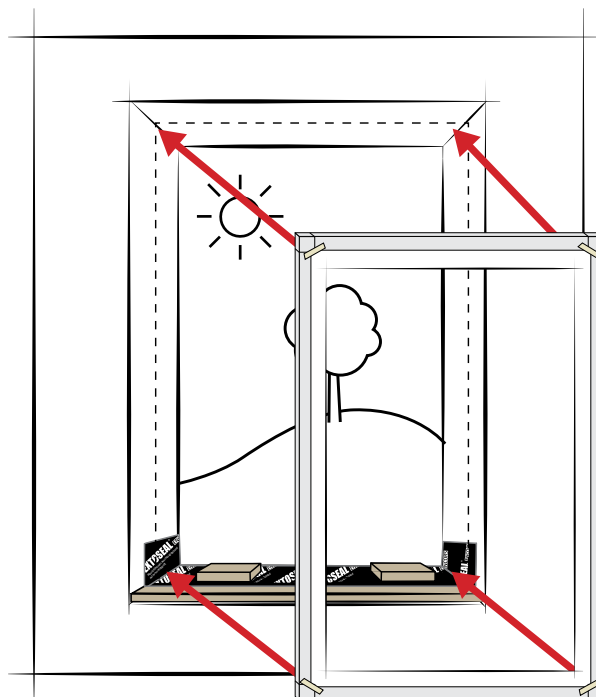

Approx.  
10 mm (3/8")

Approx. 10 mm  
(3/8")

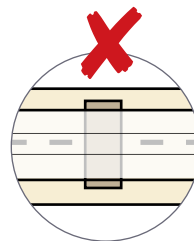

Use setting blocks made of hardwood or plastic (they must be pressure-resistant and keep their shape). They must not protrude beyond the frame.



## 2. Fasten the window properly

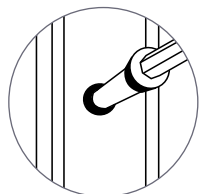
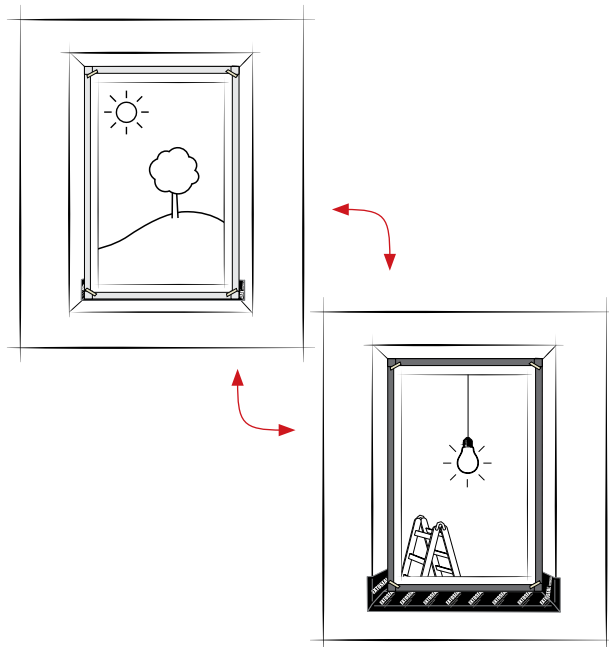
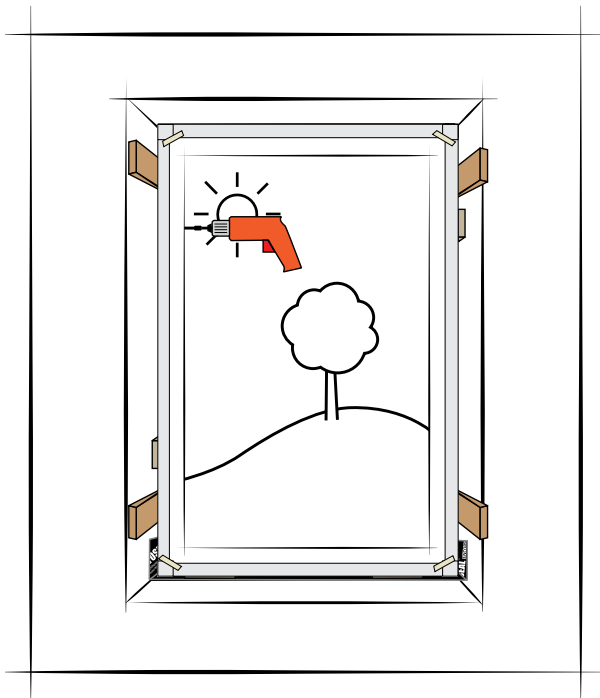

Fasten the window using a suitable fastening system

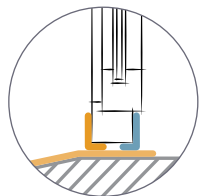

You're finished!



### Practical tip:

Should you start sealing inside or outside? Decide based on the on-site situation, such as weather conditions or the stage of progress of construction – this decision does not depend on the pro clima window-sealing tapes.



## Finishing the interior airtightness

### 1. Stick the tape all around the reveal

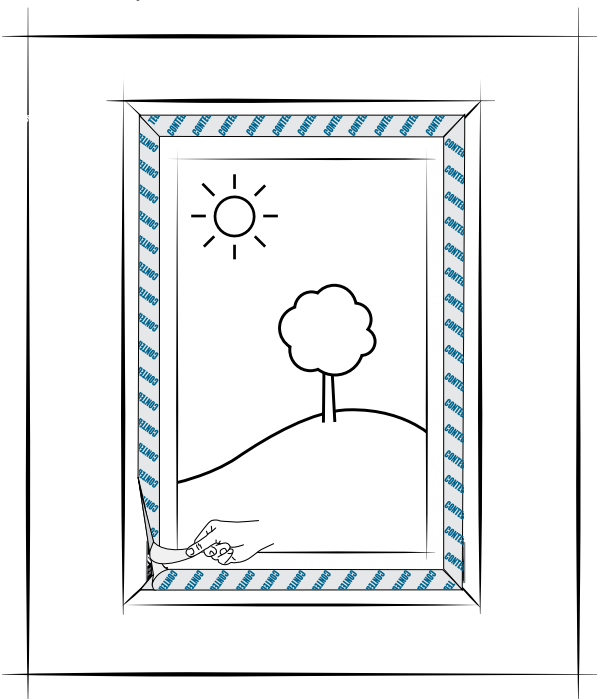

Rub in place using the PRESSFIX tool

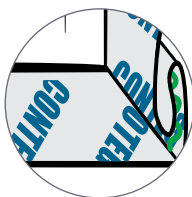

Use ORCON F adhesive at the corners if necessary

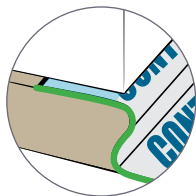

### 2. Interior airtightness: finished

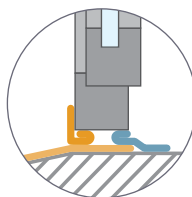
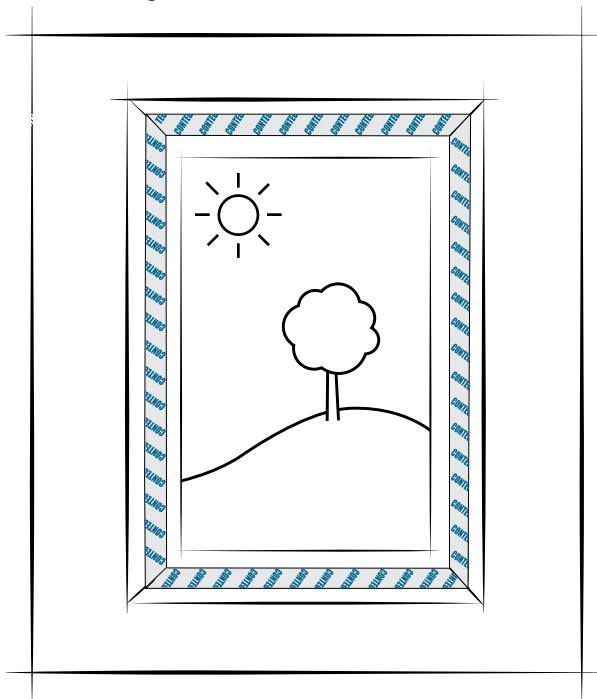

You're finished!



Apply the tape with slack to allow for movement.





## Insulating the joint

### 1. Fill the joint with insulation material

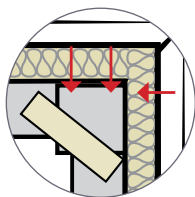
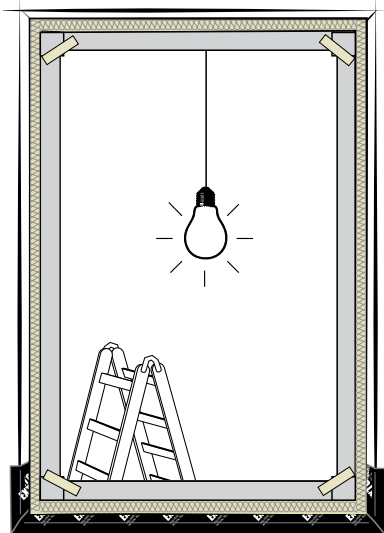

Fill the joint with insulation material around the perimeter, leaving no cavities

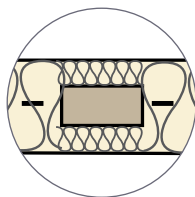

Insulate around setting blocks

#### Practical tip:

Folding over the window-sealing tape in advance will make it easier to insert the insulation. Install the insulation material around the profile, leaving no cavities, before applying the tape. This makes it easier to carry out adhesion work on the interior and exterior sealing layers.



## Installing exterior weather protection

### 1. Stick the tape all around the reveal

Remove the release film

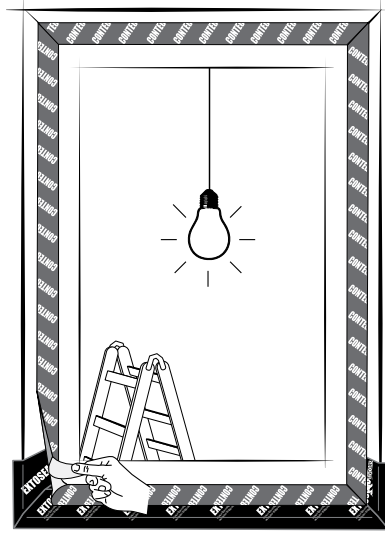

Rub using the PRESSFIX tool to secure



Use ORCON F adhesive at the corners if necessary

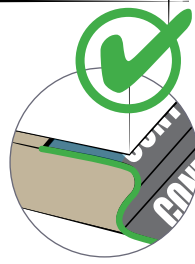

Apply the tape with slack to allow for movement.



Adhesive joints that are resistant to wind and driving rain can only be achieved if the sealing tape is installed free of folds and breaks.





## 2. Exterior weather protection: finished

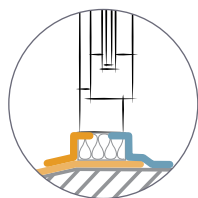
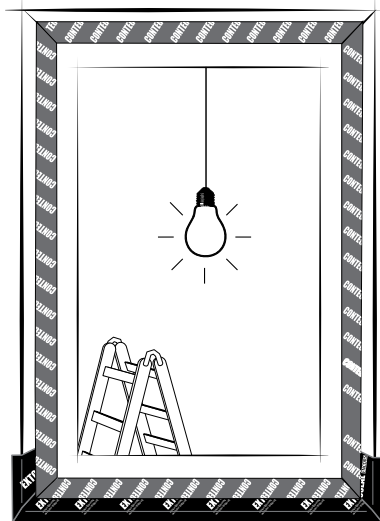

You're finished!



Install endpieces of window sills in such a way that they can be finished to be flush with the outer plaster layer. This prevents standing water from collecting on the top surface. Seal off any fasteners.



## Installation in front of the wall

### CONTEGA<sup>®</sup> SOLUDO 10

Intelligent, full-surface adhesive plaster / window-sealing tape, for interior and exterior use



### Installation steps: Externally mounted windows

Internal airtightness

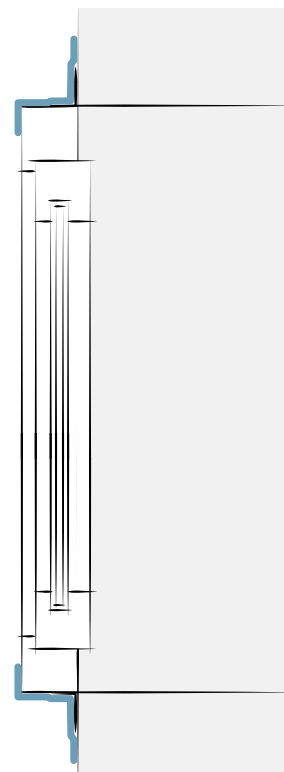

Internal airtightness



The airtightness layer takes on the function of temporary weather protection during the construction phase.



## 1. Cut the tape to size

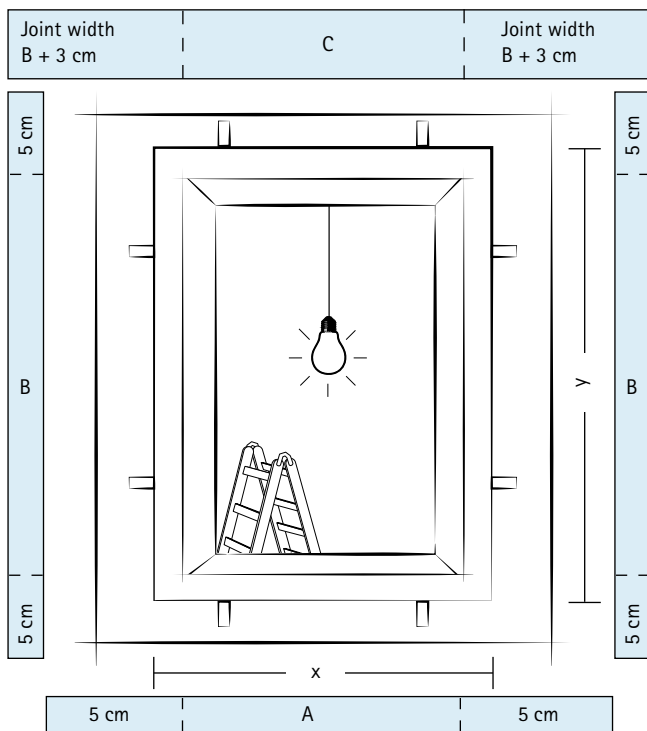

Select the tape width so that a width of 5 cm (2") is covered by the tape on the concrete/masonry. CONTEGA SOLIDO IQ should cover a width of at least 5 cm (2") on the concrete/masonry in the area around brackets/anchors.

When cutting CONTEGA SOLIDO IQ to length for the joints around the window,  $2 \times 5$  cm (2") should be added to the frame dimensions for the lower and side tape lengths to allow for corner overlaps. The joint created at the top must completely cover the width of the taped areas at the sides. If the adhesive joints are created using a number of shorter lengths of tape for a particular side, the tape overlap must always be at least 3 cm (1 3/16") at tape joints.



$$A = x + 5 \text{ cm (2")} + 5 \text{ cm (2")}$$

$$B = y + 5 \text{ cm (2")} + 5 \text{ cm (2")}$$

$$C = x + \text{double the side joint width} + 3 \text{ cm (1 3/16")}$$



## 2. Tape over brackets

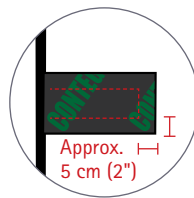
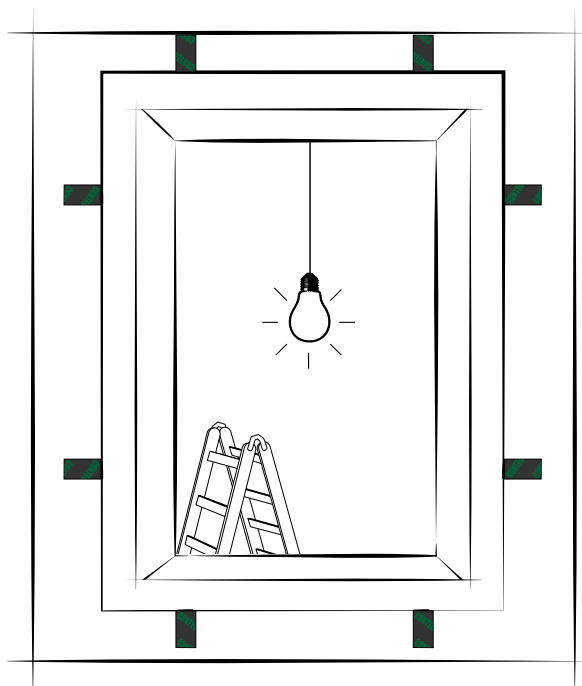

Brackets should be taped in such a way that a minimum width of approx. 5 cm (2") is achieved for adhesion to the subsurface.



### 3. Stick to the window

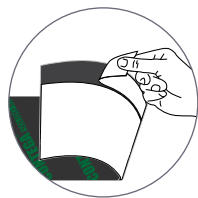
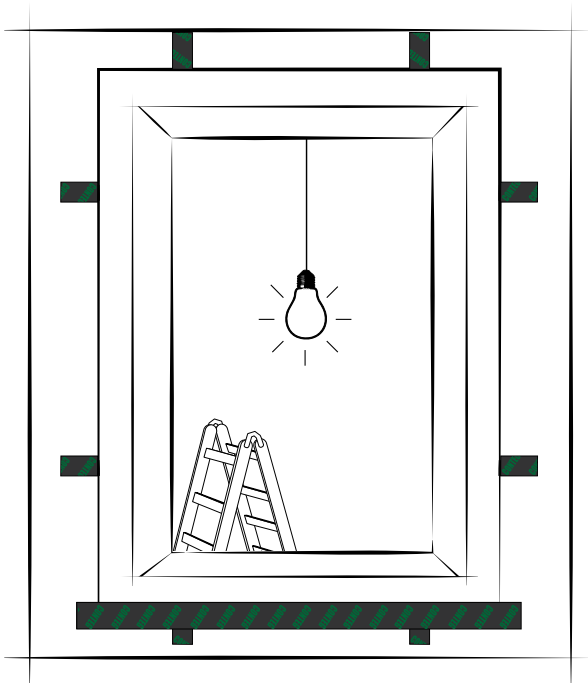

Apply the tape in a waterproof manner, starting at the bottom of the window and working up. Do not tape over any drainage openings in the window!



### 4. Stick to the wall

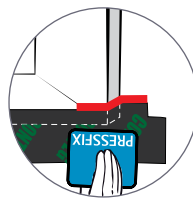
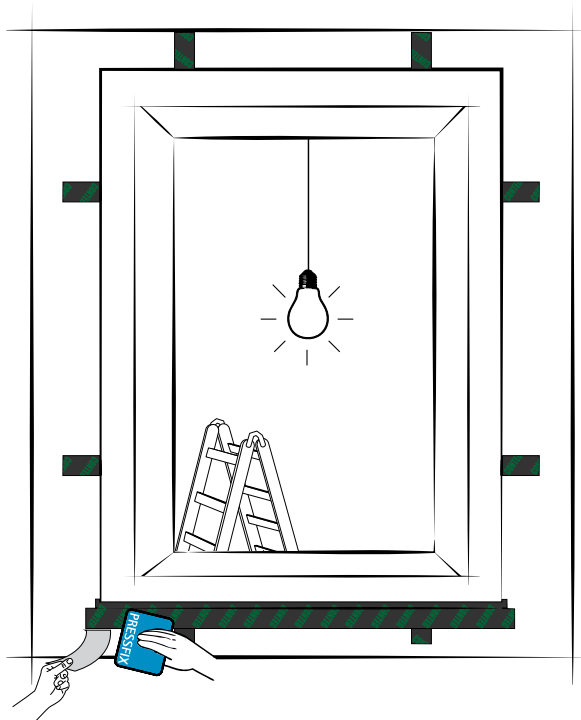

Tape application at the corners



Apply CONTEGA SOLIDO IQ around the corners of the window frame, ensuring there is no tension. Ensure that there are no folds in the outer area of the tape. After sticking, rub the tape firmly into place using the PRESSFIX application tool.



### 5. Sealing the side joints

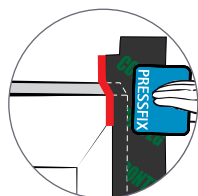
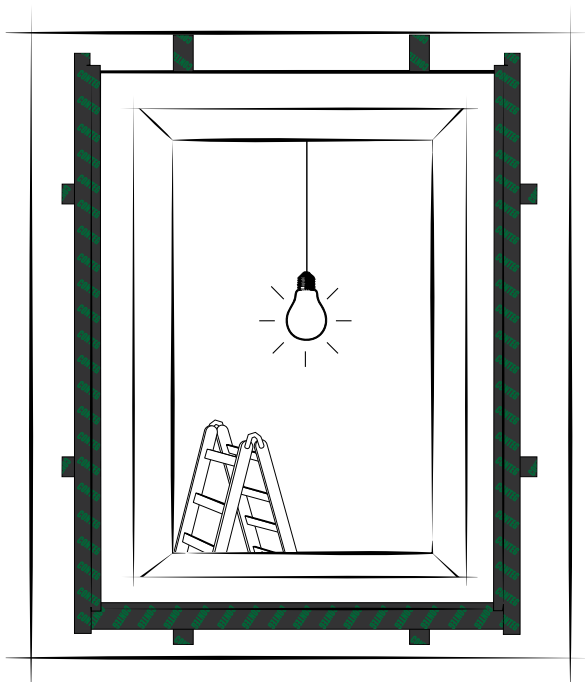

Install corner taping on the sides



### 6. Create the upper joint

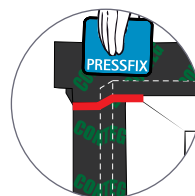
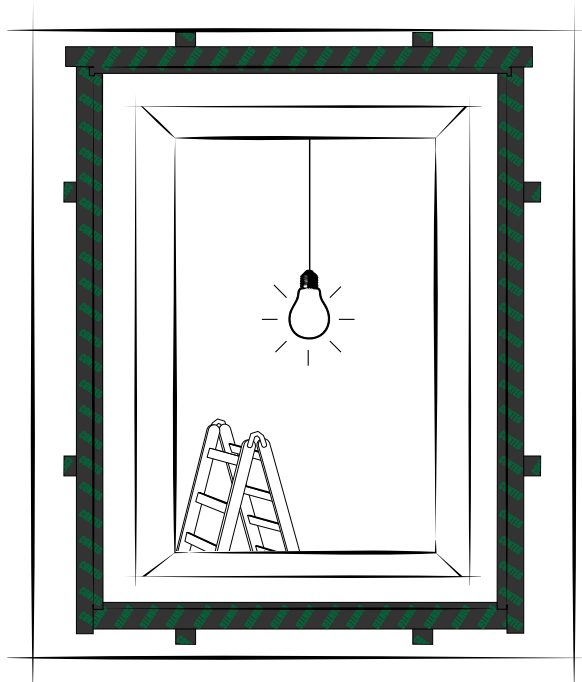

Install corner taping at the top



Apply CONTEGA SOLIDO IQ around the corners of the window frame, ensuring there is no tension. Ensure that there are no folds in the outer area of the tape. After sticking, rub the tape firmly into place using the PRESSFIX application tool.



## 7. Installation in front of the wall: finished

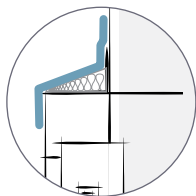
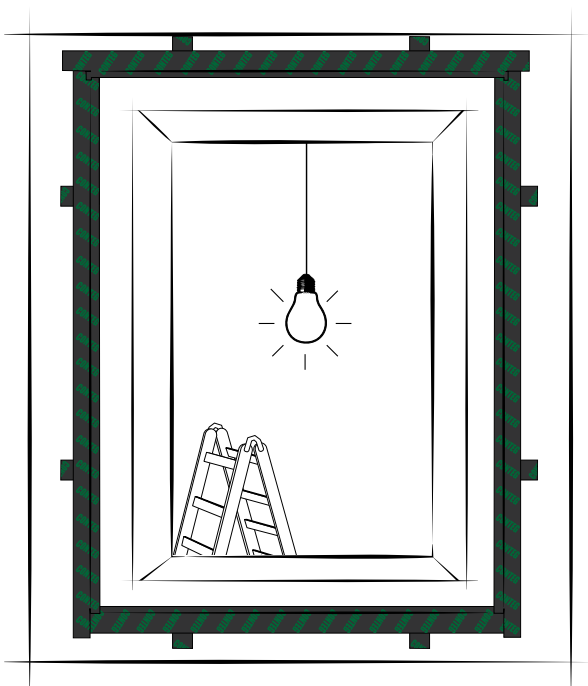

You're finished!



Before applying the tape, a wedge-shaped (insulation) profile can be installed on the window frame to prevent the collection of standing water on the top surface.



## Quality assurance, acceptance and documentation

### 1. Visual inspection

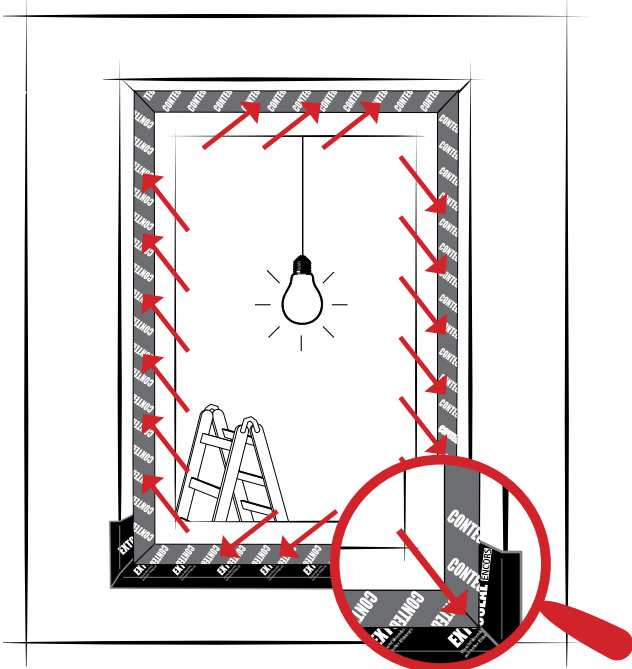

Careful visual inspection of work carried out is essential. This check, along with documentation of quality, should be carried out before other work is carried out and before other trades begin their work. At this stage, improvements can still be carried out quickly and easily – e.g. by using ORCON F.

#### Practical tip:

Take photos of the installed window. This does not take much time, but is very useful: you can document the quality of your work before subsequent trades start their work.



## 2. Differential pressure test with BlowerDoor



### BlowerDoor

The Blower Door procedure is a testing method that uses a blower fan (BlowerDoor) to create different pressure conditions inside the building relative to the atmospheric pressure outdoors. This differential pressure allows defects in joints to be identified and rectified. Quality assurance using this method is recommended during the course of building work, as possible leaks can be clearly identified and easily rectified. This procedure can also be used to measure the air change rate ( $n_{50}$ ) in the building.

#### Practical tip:

Consult with other trades (e.g. roofers, carpenters, plasterers ...) beforehand, as a Blower Door test may already be planned and a number of trades can then take advantage of this test at the same time. And the client will save money too!



## The correct position of the window in the building structure

### Window joints

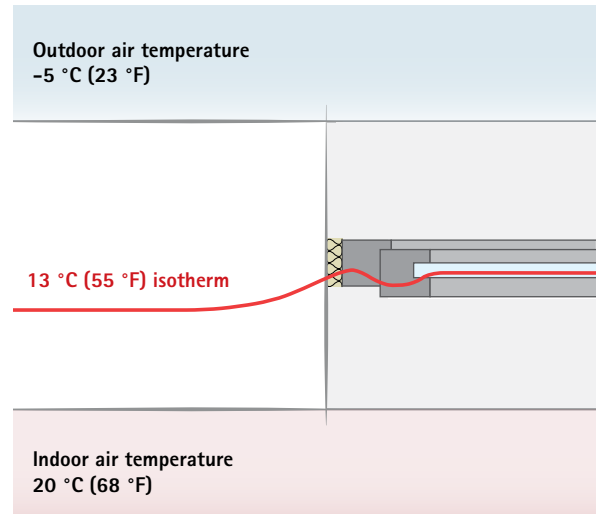

Depending on the type of wall system used, the position of the window varies as a function of the position of the 13 °C (55 °F) isotherm. This shape of this isotherm should be as smooth as possible within the overall isotherm pattern.

The window can generally be positioned in the middle of the wall. This position roughly corresponds to the course of the 13 °C (55 °F) isotherm. Significant deviations from this isotherm (= reduction in the temperature) can result in increased levels of moisture in the building component and on its surface. This leads to a risk of condensation and mould formation.



## Overview of pro clima's range of window-sealing products

### Interior + Exterior

#### CONTEGA<sup>®</sup> SOLIDO IQ-D

Intelligent full-surface adhesive plaster/window-sealing tape with additional adhesive zone, for interior and exterior use



#### CONTEGA<sup>®</sup> SOLIDO IQ

Intelligent, full-surface adhesive plaster/window-sealing tape, for interior and exterior use



#### CONTEGA<sup>®</sup> IQ

Intelligent window-sealing tape, for interior and exterior use



#### CONTEGA<sup>®</sup> SOLIDO IQ-X

Pre-folded, intelligent, full-surface adhesive plaster/window-sealing tape, for interior and exterior use

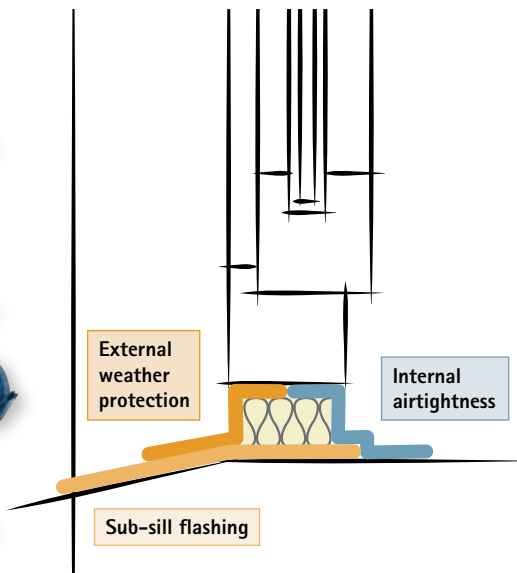

### AEROSANA VISCONN system:

Sprayable sealants for interior and exterior use

#### AEROSANA VISCONN

Sprayable airtightness sealant with humidity-variable water vapour permeability, blue/black or white



#### AEROSANA VISCONN FIBRE

Fibre-reinforced sealant with humidity-variable water vapour permeability, blue/black or white



#### AEROSANA FLEECE

Fleece for covering cracks or joints



### What do the product names mean?

SOLIDO	Full-surface adhesive, not sensitive to moisture
SOLIDO-D	Full-surface adhesive + adhesive surface on the fleece side, for simple corner details
IQ	INTERIOR + EXTERIOR, humidity-variable ... with IQ
SL	INTERIOR, airtight and vapour-checking
EXO	EXTERIOR, diffusion-open, windtight and resistant to driving rain



### Interior: Airtightness

#### CONTEGA<sup>®</sup> SOLIDO SL-D

Full-surface adhesive plaster/window-sealing tape with an additional adhesive zone on the fleece side, for interior use



#### CONTEGA<sup>®</sup> SOLIDO SL

Full-surface adhesive plaster/window-sealing tape, for interior use



#### CONTEGA<sup>®</sup> SL

2-ply plaster/window-sealing tape with vapour-checking properties

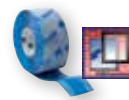

### Exterior: Weather protection

#### CONTEGA<sup>®</sup> SOLIDO EXO-D

Full-surface adhesive plaster/window-sealing tape with an additional adhesive zone on the fleece side, for exterior use

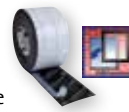

#### CONTEGA<sup>®</sup> SOLIDO EXO

Full-surface adhesive diffusion-open plaster/window-sealing tape that can be plastered over, for exterior use



#### CONTEGA<sup>®</sup> EXO

Window-sealing tape, for exterior use



#### CONTEGA<sup>®</sup> HIDDEN EXO

Pre-compressed, diffusion-open joint-sealing tape that is resistant to driving rain, for exterior use



### Sub-sill flashing

#### EXTOSEAL<sup>®</sup> ENCORS

Water-resistant adhesive tape with high adhesion

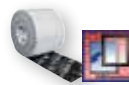





MOLL bauökologische Produkte GmbH  
D-68723 Schwetzingen  
Phone: +49 (0) 62 02 - 27 82.0  
info@proclima.com · proclima.com

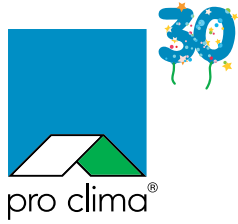

## System and product brochure



Our detailed system and product brochure for the pro clima window-sealing system describes the requirements that have to be fulfilled by window and door joints, presents relevant background knowledge, and introduces our system solutions and products.

This brochure can be downloaded here:

[proclima.info/en/downloads-windows](https://proclima.info/en/downloads-windows)



[proclima.com](https://proclima.com)

